

Dimensional Data are Subject to Manufacturing Tolerance and Change Without Notice

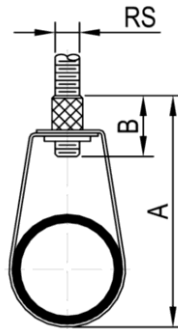

Part Number	Nominal Pipe Size		RS		A		B		Wt.		Max. Rec. Load	
	in.	mm	in.	mm	in.	mm	in.	mm	lb	kg	lbs	N
	SH01-015	1/2	DN15	3/8	M10	2 <sup>3</sup> / <sub>4</sub>	70	1	25	0.09	0.04	300
SH01-020	3/4	DN20	3/8	M10	3 <sup>1</sup> / <sub>16</sub>	78	1	25	0.09	0.04	300	1334
SH01-025	1	DN25	3/8	M10	3 <sup>5</sup> / <sub>16</sub>	84	1	25	0.10	0.05	300	1334
SH01-032	1 <sup>1</sup> / <sub>4</sub>	DN32	3/8	M10	3 <sup>9</sup> / <sub>16</sub>	90	1	25	0.10	0.05	300	1334
SH01-040	1 <sup>1</sup> / <sub>2</sub>	DN40	3/8	M10	3 <sup>13</sup> / <sub>16</sub>	97	1	25	0.11	0.05	300	1334
SH01-050	2	DN50	3/8	M10	4 <sup>1</sup> / <sub>4</sub>	108	1	25	0.12	0.06	300	1334
SH01-065	2 <sup>1</sup> / <sub>2</sub>	DN65	3/8	M10	4 <sup>7</sup> / <sub>8</sub>	124	1	25	0.27	0.12	525	2334
SH01-080	3	DN80	3/8	M10	5 <sup>11</sup> / <sub>16</sub>	144	1	25	0.32	0.14	525	2334
SH01-090	3 <sup>1</sup> / <sub>2</sub>	DN90	3/8	M10	6 <sup>7</sup> / <sub>64</sub>	155	1	25	0.33	0.15	585	2600
SH01-100	4	DN100	3/8	M10	6 <sup>7</sup> / <sub>8</sub>	174	1	25	0.38	0.17	650	2890
SH01-125	5	DN125	1/2	M12	8 <sup>3</sup> / <sub>16</sub>	208	1 <sup>1</sup> / <sub>4</sub>	32	0.56	0.25	1000	4445
SH01-150	6	DN150	1/2	M12	9 <sup>5</sup> / <sub>8</sub>	245	1 <sup>1</sup> / <sub>4</sub>	32	0.67	0.31	1000	4445
SH01-200	8	DN200	1/2	M12	12 <sup>9</sup> / <sub>16</sub>	313	1 <sup>1</sup> / <sub>4</sub>	32	0.78	0.35	1000	4445

Size Range: 1/2" - 8"

Material: Carbon Steel

Finish: Plain / Galvanized/ Hot Dipped Galvanized

**Richang Qiaoshan Trade Co., Ltd.**

1-256, No. 35 Zhenxing Road, Changping, Beijing, China 102200

Ph: 86-10- 64644308 Fax: 86-10-64644308

[www.qiaoshan.co](http://www.qiaoshan.co)

Date: Aug-24

Dwg. No. : **QSH01**